

Begane grond

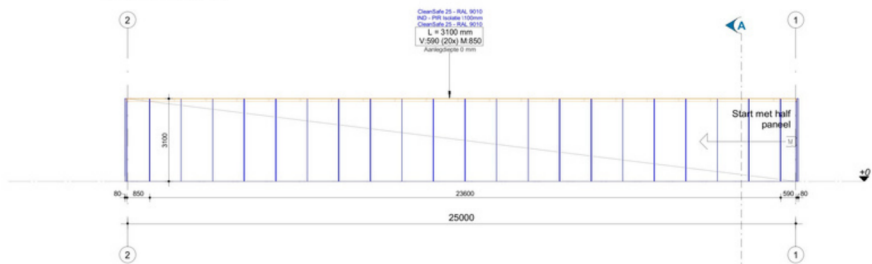

Achtergevel

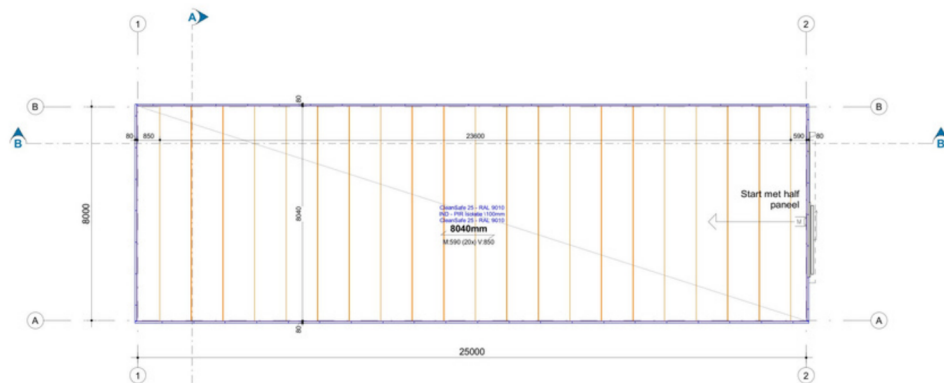
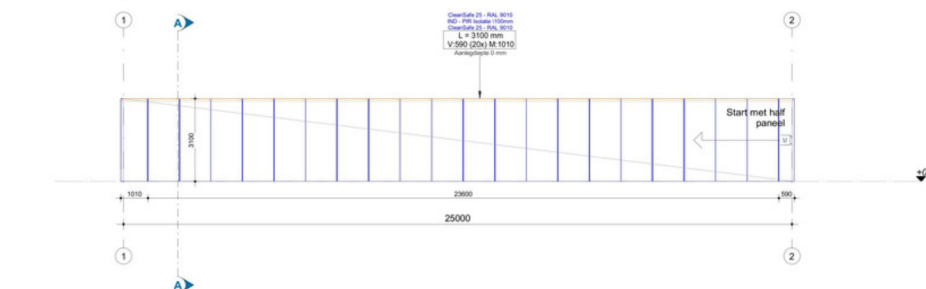

Voorgevel

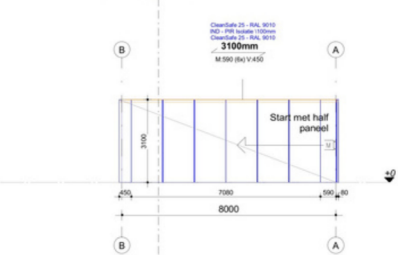

Linkergevel

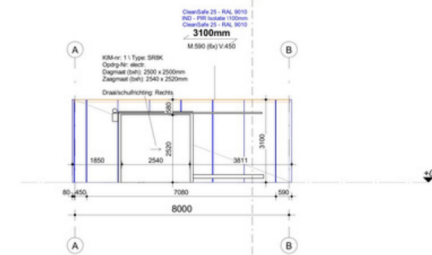

Rechtergevel

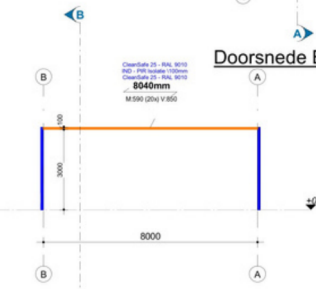

Doorsnede A

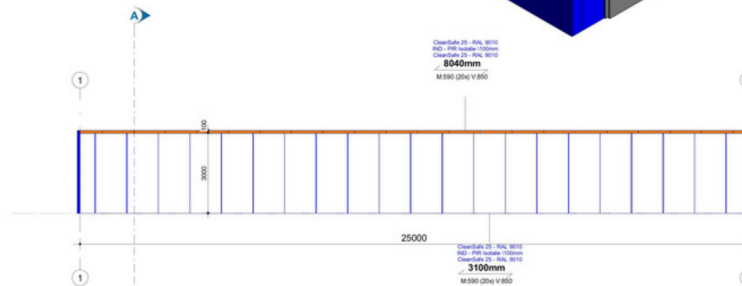
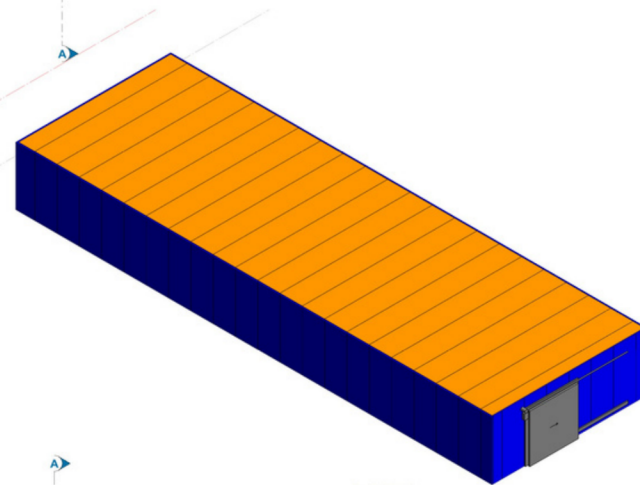

Doorsnede B

ALGEMEEN

Algemeen: De bouwtekeningen worden opgesteld op basis van de bestaande situatie en worden niet aansprakelijk gemaakt voor de juistheid van de afgeleide gegevens. De afgeleide gegevens worden niet aansprakelijk gemaakt voor de juistheid van de afgeleide gegevens.

GEVELPANELEN

A - K.I.M. PIR sandwichpanelen 100 mm	
Werkelijke breedte = 1190 mm	
Werkende breedte = 1180 mm	
RC = 7 m ² /KW	

Bovenzijde	Binnenzijde
Afwerking: G.L.Afwerk. 25	G.L.Afwerk. 25
Kleur: Ral 9010	Ral 9010
Profiel: Standard profiel	Standard profiel

PLAFOND PANELEN

E - K.I.M. PIR sandwichpanelen 100 mm	
Werkelijke breedte = 1190 mm	
Werkende breedte = 1180 mm	

Bovenzijde	Onderzijde
Afwerking: G.L.Afwerk. 25	G.L.Afwerk. 25
Kleur: Ral 9010	Ral 9010
Profiel: Standard profiel	Standard profiel

Description

Piping system for refrigeration system made in carbon steel P235GH and/or K65 CU designed in accordance with MD no. 06/42/EC + PED no. 2014/68/EU.

Assessments of conformity (declaration of conformity)
Standards for manufacturing: EN13480 / EN378
Classification of assemblies: 2014/68/EU – article 13

Classification of refrigerant group II: CO2
Charge of refrigerant: 53 kg

Design conditions:
Allowable temperatures: -50 – 150°C
Design pressure:
Suction side: MT/LT: 52/30 bar
Discharge side: MT/LT: 120/52 bar
Receiver: 80 bar
Test pressure: 57,2 / 33 / 88 / 132 bar (nitrogen/Air)

Leak test according to Advansor ISO 9001 procedure: P_09_04.

Pipes:
Material: Carbon steel, P235GH, EN10216-2 + K65 CU
In accordance with construction manual: TI-11.001/TI-13.001/TI-14.001

Frame: Carbon steel

Bends, reductions, and caps, T-fittings:
Material: P235GH, EN10216-2 + CU K65
In accordance with construction manual: TI-11.001/TI-13.001/TI-14.001

Fittings for welding and mounting:
Fittings for welding: P235GH, EN10216-2
In accordance with construction man: TI-11.001/TI-13.001/TI-14.001

Certificates of material:
Certificates EN 10204 Type 3.1.B
Material requirements according to PED 2014/68/EU annex 1 section 4

Connections:
Refrigeration system: Welding / Soldering
Oil system: Thread and compression fittings

Specifications for welds:
PED no. 2014/68/EU, annex 14, section 6
Welding procedure: EN 15609-1, EN 15614-18
Certification of welder: EN 287-1, EN 9608-1

Specifications for soldering:
Connections according to 2014/68/EU annex 1 section 3.
Soldering procedure: EN 13134:2000

Supports of piping:
In accordance with EN 378-2, section 6.

Insulation (pipes and vessels):
Cold surfaces: Kaliflex
Hot surfaces: Optional

Surface coating:
Pipes: One Coat, PPG Selemix 7-535, Glans 50 Ral 7032.
Frame / vessels: PPG Selemix 7-535, Glans 50 Ral 7032.
K65 CU: None

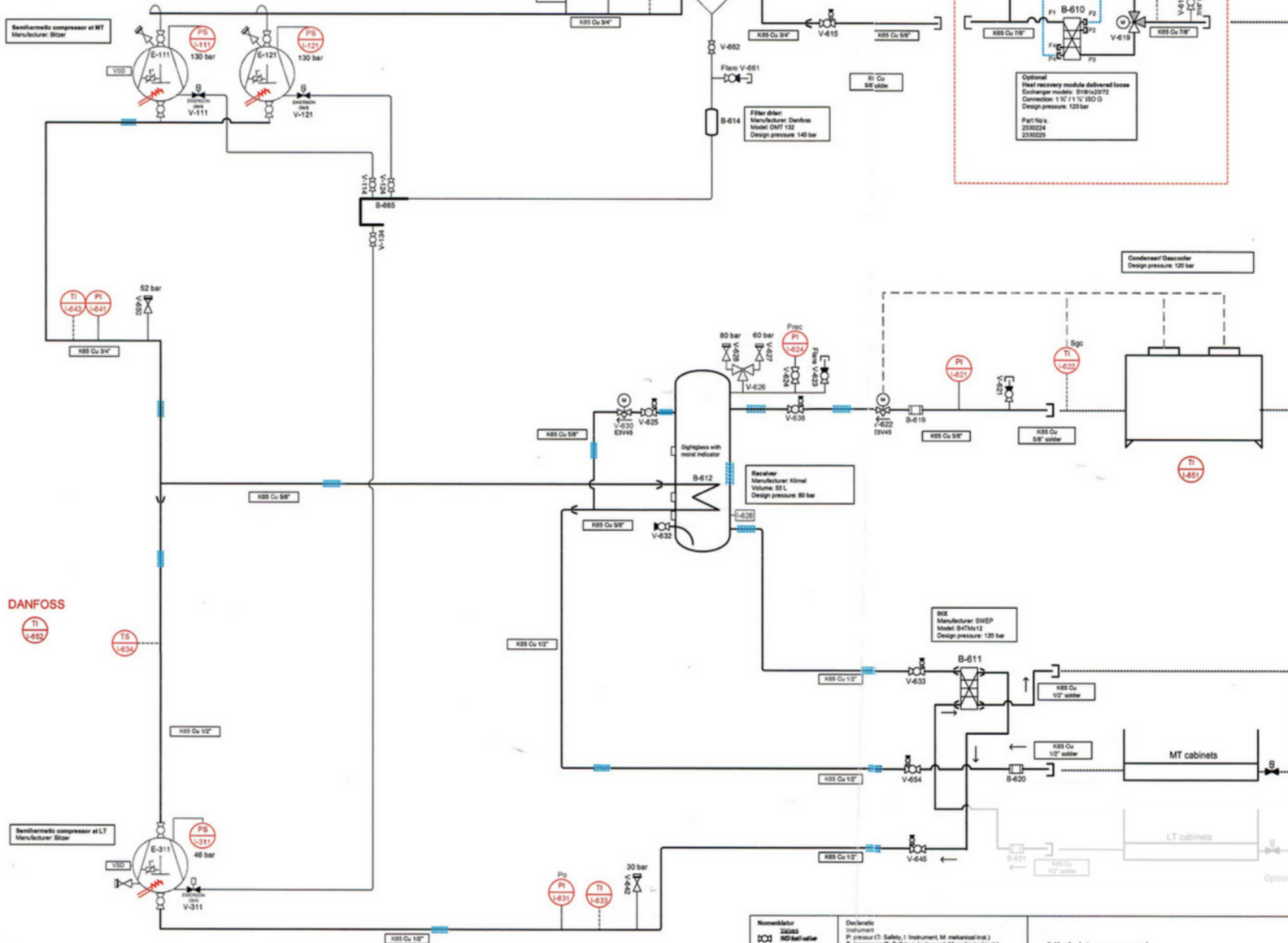

	Separator	DCM	DCM	DCM	DCM	DCM	DCM	DCM	DCM
	Sight Glass		Receiver		Condenser		Compressor		Valve
	Filter		Receiver		Condenser		Compressor		Valve
	Sight Glass		Receiver		Condenser		Compressor		Valve
	Sight Glass		Receiver		Condenser		Compressor		Valve

All rights reserved:
No part of this information or design of drawings may be reproduced, without the prior written permission of Advansor A/S

Model	MiniBooster 2x1-1R		
Item no's.	5000002-00, 5000003-00, 5000004-00, 5000005-00, 5000007-00, 5000008-00, 5000009-00, 5000010-00, 5000012-00, 5000013-00, 5000026-14, 5000015-00, 5000017-00, 5000018-00, 5000019-00, 5000020-00, 5000022-00, 5000023-00, 5000024-00, 5000025-00, 5000027-00, 5000028-00, 5000084-00, 5000085-00, 5000089-00, 5000090-00	-	-
	5000091-00	-	-
Drawing No.	Init.	Revision	Date
	RNN	Rev 0	26-05-2020
80.0017 Template rev. no.: 01	-	-	-
	-	-	-

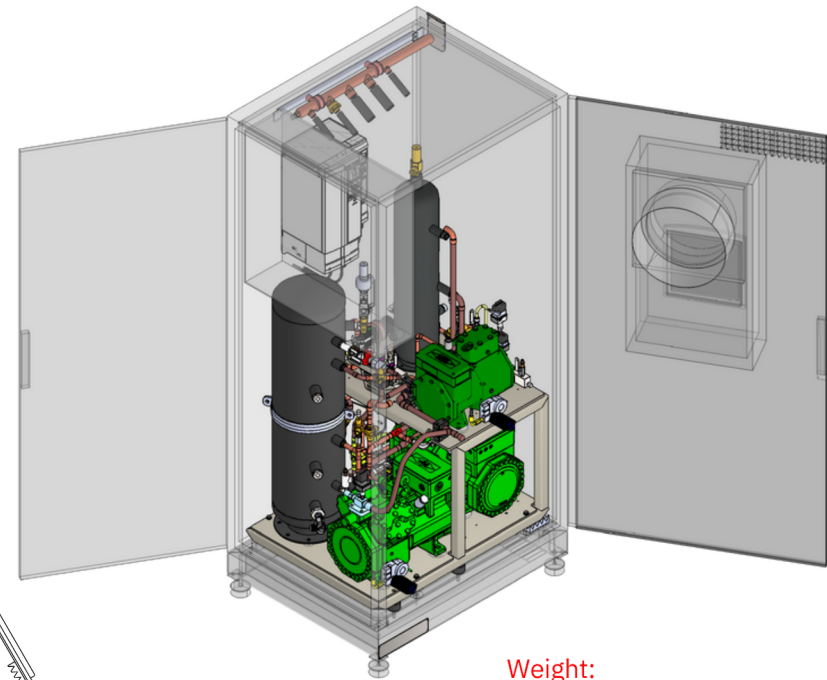
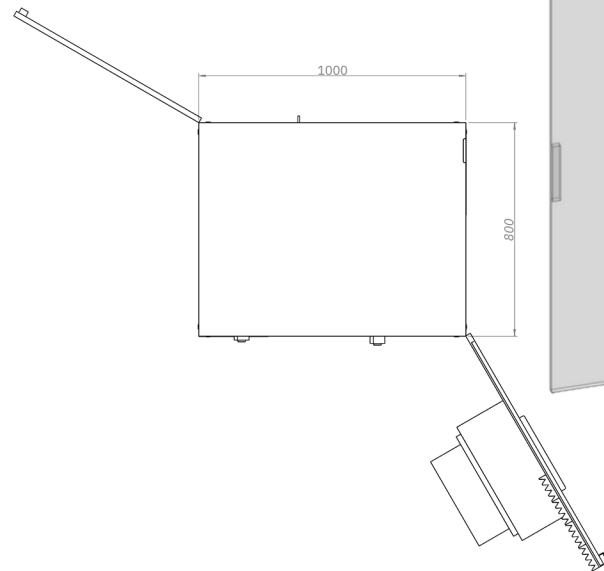
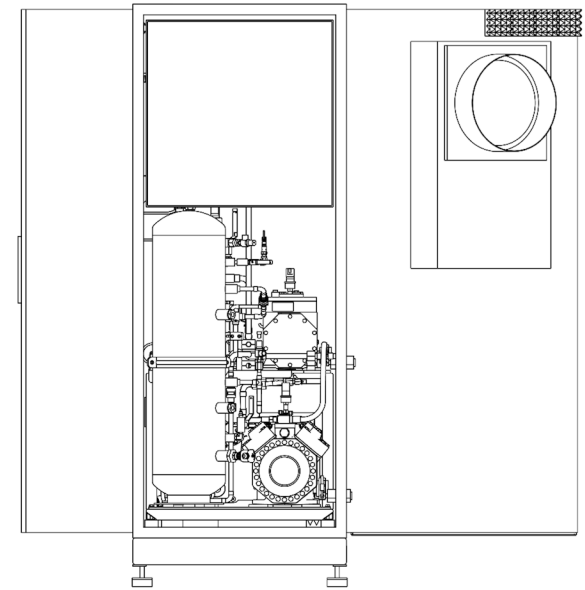
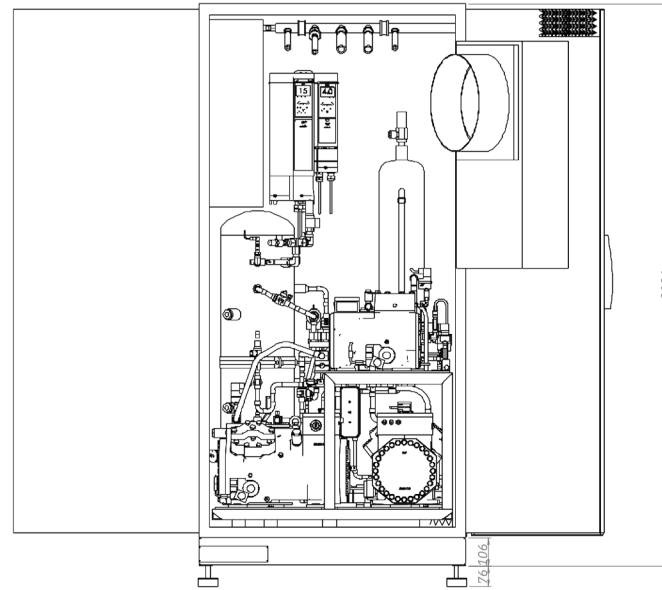
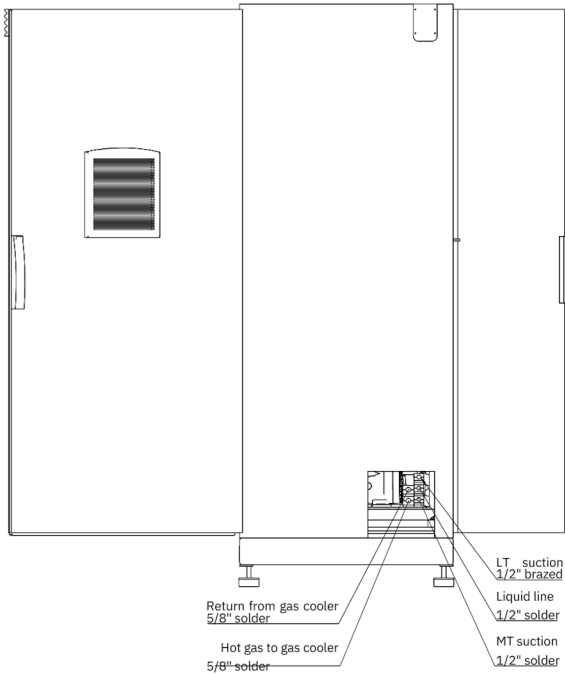

Weight:
 Configuration 2x1: 780 kg+ Heat-recovery 40 kg
 Configuration 2x0: 720 kg+ Heat-recovery 40 kg

<small>ADVANSOR DPM AND COMPRESSORS: The information contained in this drawing is the sole property of ADVANSOR A/S. Any reproduction or use in any form without the written permission of ADVANSOR A/S is prohibited.</small>			ADVANSOR		Weight:- Kg.		Scale 1:10	List Date	PK 14-06-2022
<small>Advansor general standards must be followed unless stated.</small>			ADVANSOR A/S Blatvang 1A, 4210 Arhus V Tel: +45 72 17 0174 info@advansor.dk www.advansor.dk		Configuration XXS 2xX MiniBOOSTER 2.0 202X-xxxx		Page: 1 of 5		
Rev.	Date	Comment							
Material									

Only for purchase of servex house

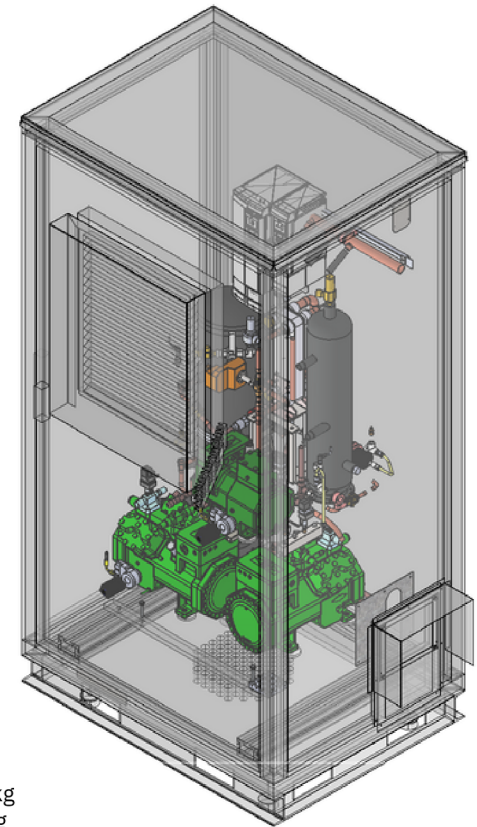
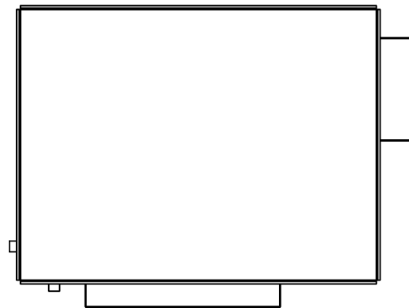
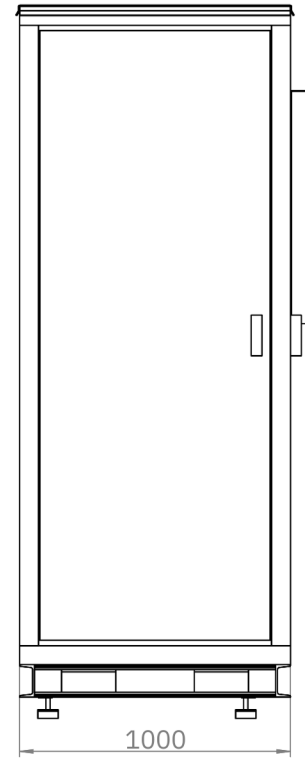
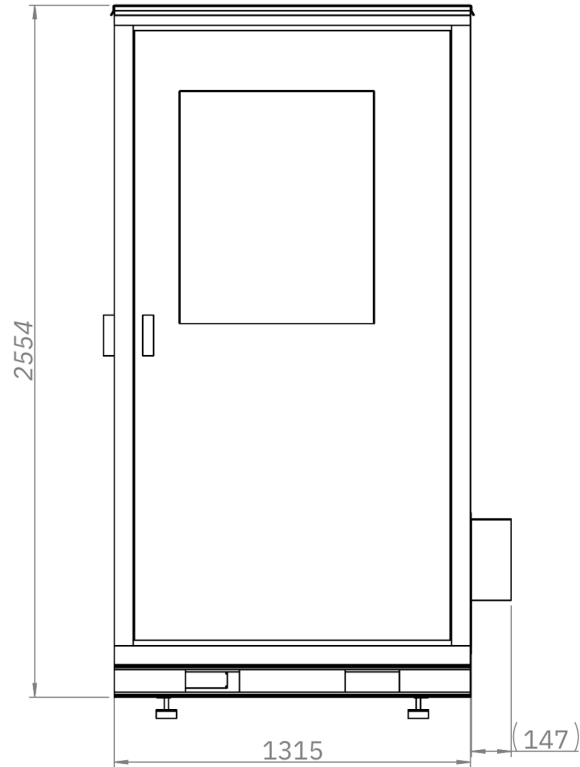
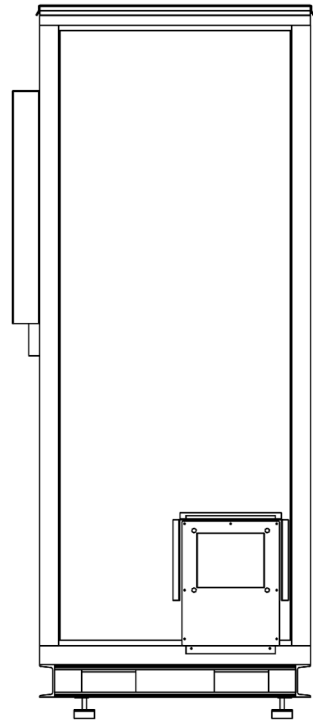

Weight:
 Configuration 2x1+ HR in Enclosure 1130 kg
 Configuration 2x0 + HR in Enclosure 1070 kg

PROPRIETARY AND CONFIDENTIAL: The information contained in this drawing is the sole property of ADVANSOR A/S. ANY reproduction in part or as a whole without the written permission of ADVANSOR A/S is prohibited. Advansor general standards must be followed unless else is stated.			ADVANSOR <small>THE PHOENIX</small>		Scale 1:20	Init PK
			Page: 2 of 5		Date 16.06.2020	Rev.
Rev	Date	Comment	Description XXS 2xX MiniBooster - Bitzer 202X-xxxx			
			Material			
			Drawing no XXS MINIBOOSTER 2			

Customer advansor
 Date 16/12/2020
 Project gas cooler - KCE 62M4 V G722 SPM C10 EC CB CB3 SP15 PV SHC

Fluid	R744 superheated		Lp(A) @ 10m	35
HxLxP	[mm]	see drawing	Outer Area	[m ²] 166
Inner Volume	[l]	13	Inner Area	[m ²] 7
Air Side		R744 side		
Entering temperature	[°C]	34	Entering temperature	[°C] 106,1
RH Entering	[%]	50	Outlet temp	[°C] 35,6
Flow	[m ³ /h]	12525	mass flow	[kg/h] 673
Barometric Pressure	[kPa]	101,325	Pressure	[bar] 0,7
Altitude	[m]	0	Pressure	[bar] 90
fan type	2 x MN286053		Total Capacity	[kW] 40,7

H brackets included

400/3/50
 absorbed power W 400
 rpm 700
 weight kg 255
 V 5,2

Inlet 1 x 22,23 7/8"
 Outlet 1 x 15,87 5/8"

